

Easton Village Hall



**REPRESENTATION INFORMATION
MR & MRS BEARDOW**

Location



This is a large and imposing building in a small conservation village, with very close proximity to several residential properties

Noise will carry across the open space – there are no natural sound barriers

Proximity to residential dwellings



The nearest property (housing 3 young children) is under 5m away.
Our own home is less than 15m

Hall



The hall itself is much larger than the previous building, with many more windows and doors, including one whole wall of doors, therefore more opportunity for noise nuisance

This also clearly shows the external areas which would be used by people when the hall is in use

Proximity to our home



This shows the proximity of our own home to the hall. Noise from the hall has a direct path to upper story windows that are connected to children's bedrooms

Both children are of school age and sitting exams this year and next

Nearest homes



From the boundary of our home



Taken from boundary of our home – distance to hall approx 15m. Hall car park is area in foreground. It shows the doors and windows that directly face our property and would be the main source of noise nuisance

There are also paved areas directly outside the hall and these doors where smokers and drinkers would congregate

Additional doors



These additional doors were added and would be the source of direct noise nuisance for neighbours to the hall

The area where smokers and drinkers would congregate is also visible

From doors to our home



This shows the closeness of the external areas to our home

Closeness to residential homes



This shows the proximity to South Cottage – approx 20-25m

Natural sound insulation of old hall



The old hall was built directly against the banking and so there was a natural sound absorption.

The new hall has a large gap here and so noise will not be deadened

Proximity to nearby residences



This shows how close the hall is to Elmbank

In places it is under 5 metres

At Elmbank there are 3 small children with bedroom windows directly adjacent to the hall and areas where people would be standing outside, smoking and drinking

Comparison with old hall



New hall is a far bigger structure with many more windows and a far higher capacity. It is no longer a small village hall and should not be treated the same way in licensing. It is major potential nuisance.

Financial need for usage



Barn Dance 2010

I know it is a long time until summer – but it is somehow comforting to think about a warm summer's evening swirling around a barn with your friends and family.

Michael has proposed Saturday 3 July for our third Barn Dance at Grace's Farm, Martyr Worthy in aid of Easton Village Hall. In the next few weeks and months we will organise band, shelter, food, booze and loos and we will provide you with all necessary information closer to the time.

But there is something you can do in the meantime - actually two things. Firstly we are again looking for sponsors (corporate and private) to cover some of the initial set up costs

(i.e. the band, hog roast, insurance etc.) so that we maximise the profit. If you feel you can help please contact me - any donations will be welcome (local businesses will have their company name printed on the tickets).

Secondly we feel that this year it is time again to run a bigger Silent Auction for which we need great prizes. So if you have a special talent or something else you could donate (i.e. a day's gardening help, the use of a holiday house, a boat for a weekend's sailing or a helicopter ride (wonder who we could ask for that?)) they would be most welcome.

We are aiming to have 200+ people attending....but the more the merrier and we hope to attract as many people from outside the village as possible.

So mark the date in your diaries, invite your friends and families and I look forward talking to you around May (and not on the 2nd of July!) when the tickets go on sale.

*Ina Williams 779465
On behalf of Easton Village Hall
Events Committee*

The hall was finished on borrowed money and requires significant revenues to cover those costs.

The puts a great deal of pressure on the trustees to hold frequent events of over 200 people to maintain loans and the property

This is not a simple village hall



Introducing a new Logo for Easton Village Hall

A friend of mine works in a prestigious advertising firm in Hamburg, Germany and I asked her to design a simple Logo for our new Village Hall to be used on letterheads, correspondence, t-shirts...



After many emails, meetings and comments the committee has decided on the logo you see here. The idea behind the logo is that the white circle represents the community surrounded by countryside (green). The big V is the V from Village Hall which symbolically supports the community. The blue wiggly bit of the V is of course our river Itchen. We all think a simple, elegant to-the-point logo. Can't wait to see it in print.

Ina Williams

On behalf of Easton VH Committee

The development of a logo indicates a much more commercial attitude towards the hall lettings. The clear implication is that the hall is required to make money and this logo is to be used in promotion of the hall.

This is a major departure from the previous hall usage and will be used to encourage a far greater number of events and bookings from people with no connection or affinity for the village. This will undoubtedly lead to intense nuisance for residents

Hall is not just for Easton



As for the hire charges for the Main Hall: weekday rates (Mon 9am till Fri 6pm) for Local Residents (Martyr Worthy, Itchen Abbas and Avington) are £10 per hour and the weekend rates (Fri 6pm - Sun 11:30pm) are £12.50 per hour. Residents of Easton will benefit from a 20% discount making it £8 and £10 respectively. The rates for Non-Residents and Commercial hirers are £20 per hour weekdays and £25 per hour on weekends. The Club room will cost £7.50 per hour at anytime (weekdays / weekends / all

hire groups) with limited availability (on request only) during the Cricket season. Later we will also introduce rates for the entire facility.

We've thought very hard about the rates basing them on village halls nearby and halls that provide similar facilities. These rates will be in place for the first few months while we gain some experience, then we will review them.

There are some further rules which will all be explained when you enter the booking process but here are a few. The minimum hire is 2 hours per session and the hours for which the hall is booked includes setting up and clearing up times. Hire for

part of an hour is charged at the full hourly rate. More regular lets (we call them multiple lets) like the WI, Mothers and Toddlers or a course of Pilates will attract a 50% discount per hour. This discount is not available at weekends. All hirers will have to comply strictly with the fire and safety rules.

I hope all this makes sense and as I am fairly new to this job please be nice to me. I promise I will do my best. I am also keen to receive feedback, comments and suggestions.

The hall is intended to be let from wider afield and for a wider range of activities on multiple occasions. The letting of the entire facility indicates the desire to have events with much larger audiences.

It is a community centre, not a village hall



HAMPSHIRE  CHRONICLE

Villagers see community centre dream come true

10:34am Monday 14th June 2010

By Chris Harris

PROUD villagers have hailed their new £420,000 community centre which was officially opened on June 5.

Scores of householders in Easton turned out for the unveiling of the venue, which includes a community hall and cricket pavilion.

It has taken more than a decade to come to fruition.

BBC reporter Robert Hall, the driving force behind the new centre, said: "I think I can't quite believe it to be honest.

"To stand here and see it is fantastic and to see so many of the community is great."

A third of the cash was raised from events held in the village, while the rest came from donations and grants.

"I think we all think it's one of the best facilities in the valley," added Mr Hall.

"The community are over the moon about it — we have had a huge amount of support both in terms of finance and time."

Winchester MP Steve Brine, who lives in Easton, said: "You'll struggle to find a village hall that's more of the community.

"It's been a very long process and many twists and turns and disappointments along the way, but everybody always believed we could do it.

"People like Robert Hall have put so much into it; in the village we call it The Robert Hall!"

Geoffrey Burnand, chairman of Easton and Martyr Worthy Cricket Club, said: "The hall will help us attract new members and it gives us far greater facilities to enjoy our cricket from — before it was pretty grim to say the least!"

© Copyright 2001-2010 Newsquest Media Group

<http://www.hampshirechronicle.co.uk>

This reinforces the desire to use the hall for much wider range of activities and for a much wider community.

As such, it should have more conditions to protect the surrounds residents.

Hall capacity is much higher than before

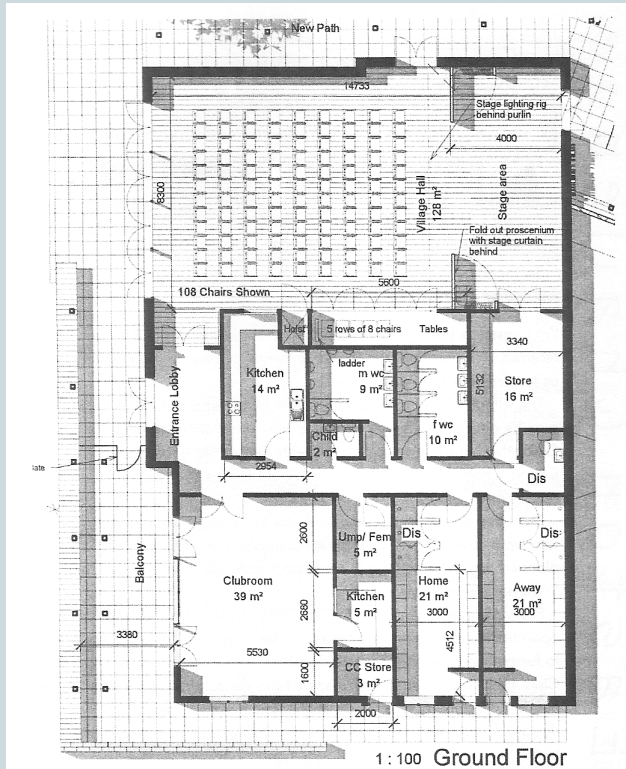

The number of people that can be accommodated inside and now outside is much higher than before

If used to it's full capacity, there would be several hundred people at the site